



ref. **1** Life 1 - Spazio doccia multifunzione con 2 ante girevoli / Multi-function shower space with two curved pivoting sections



ref. **3** Life 3 - Box doccia multifunzioni con porta a battente e 2 ante fisse / Multi-function shower cubicle with hinged door + 2 fixed panels

# Life

altezza box / *shower height*

**200 cm**

altezza totale / *total height*

**215 cm**

crystallo trasparente / *clear glass*

**8 mm**

ref. **3** **Life 3** - Box doccia multifunzioni con porta a battente e 2 ante fisse / *Multi-function shower cubicle with hinged door + 2 fixed panels*

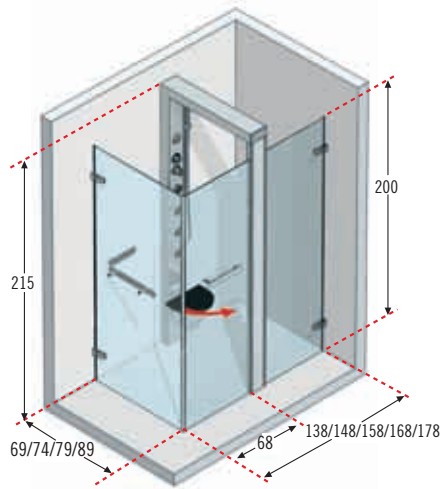

Reversibile / *Reversible*

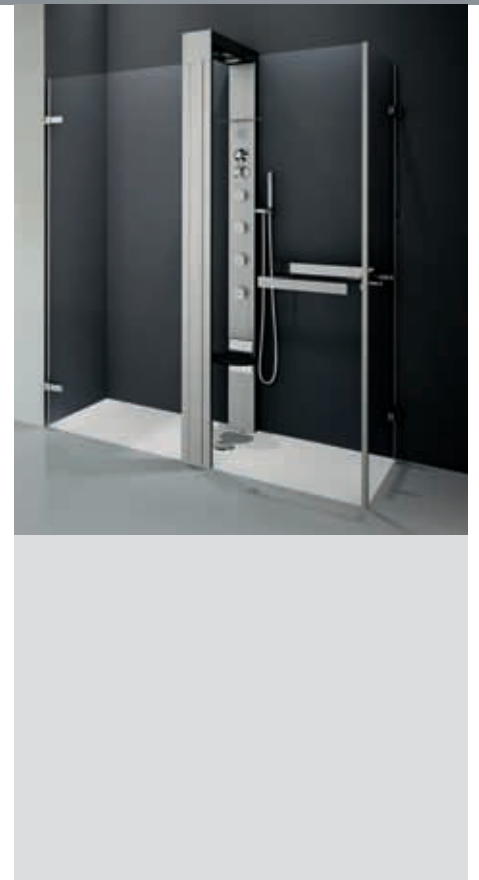

Disegni tecnici / *Technical drawings pag. 112.*

Codice/Code: **LIFE8314070-1B**

= **LIFE8314070-** + **1** + **B**

Esempio compilazione codice:

How to choose your product using the codes:

LIFE8314070-	1	B
--------------	---	---

Misure Measurements (cm)	Entrata Access (cm)	VERSIONE CROMOLIGHT* CHROMOLIGHT VERSION*			VERSIONE EASY* EASY VERSION*		
		Codice / Code	Vetro / Glass	Profilo / Profile Prezzo / Price	Codice / Code	Vetro / Glass	Profilo / Profile Prezzo / Price
			1	B		1	B
			Trasparente Clear	Silver		Trasparente Clear	
138 x 69	67	LIFE8314070-			LIFE8314070E-		
148 x 69	67	LIFE8315070-			LIFE8315070E-		
158 x 69	67	LIFE8316070-			LIFE8316070E-		
168 x 69	67	LIFE8317070-			LIFE8317070E-		
178 x 69	67	LIFE8318070-			LIFE8318070E-		
138 x 74	67	LIFE8314075-			LIFE8314075E-		
148 x 74	67	LIFE8315075-			LIFE8315075E-		
158 x 74	67	LIFE8316075-			LIFE8316075E-		
168 x 74	67	LIFE8317075-			LIFE8317075E-		
178 x 74	67	LIFE8318075-			LIFE8318075E-		
138 x 79	67	LIFE8314080-			LIFE8314080E-		
148 x 79	67	LIFE8315080-			LIFE8315080E-		
158 x 79	67	LIFE8316080-			LIFE8316080E-		
168 x 79	67	LIFE8317080-			LIFE8317080E-		
178 x 79	67	LIFE8318080-			LIFE8318080E-		
138 x 89	67	LIFE8314090-			LIFE8314090E-		
148 x 89	67	LIFE8315090-			LIFE8315090E-		
158 x 89	67	LIFE8316090-			LIFE8316090E-		
168 x 89	67	LIFE8317090-			LIFE8317090E-		
178 x 89	67	LIFE8318090-			LIFE8318090E-		

\*Caratteristiche versione Cromolight vedi pag. 108 / Technical specifications for Cromolight version page 108.

\*Caratteristiche versione Easy: soffione, doccia, sedile / Technical specifications for Easy version: fixed shower head, hand shower, folding seat.

Finiture versione cromolight / Features chromolight version

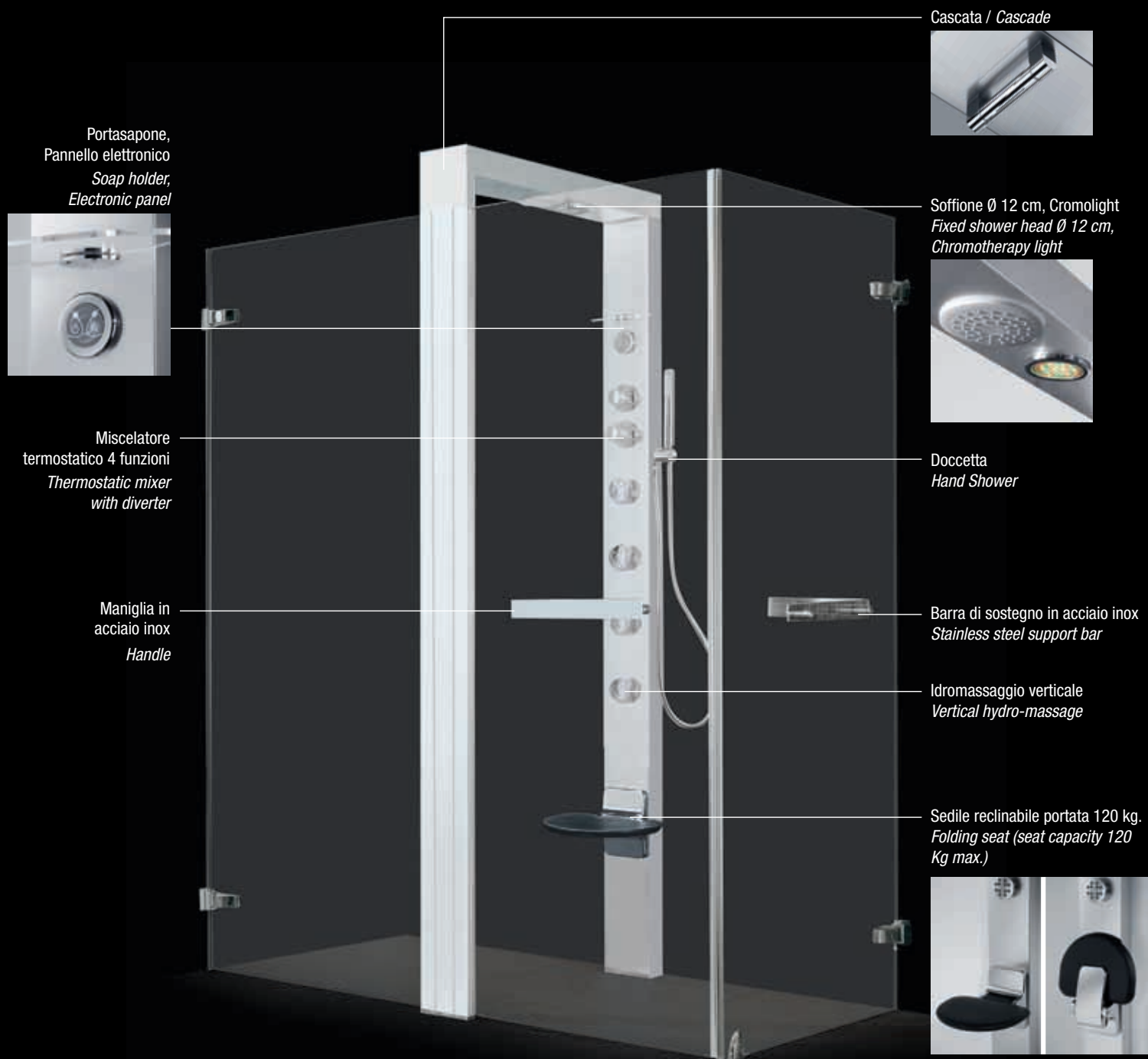

Vetro trasparente  
*Clear glass*



Silver

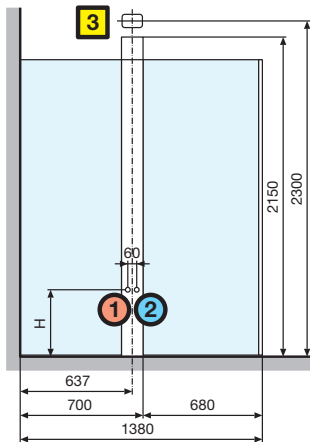

400 ≤ H ≤ 500

LIFE8314070-1B    LIFE8314080-1B  
LIFE8314075-1B    LIFE8314090-1B

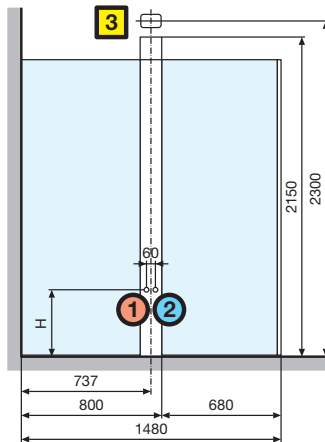

400 ≤ H ≤ 500

LIFE8315070-1B    LIFE8315080-1B  
LIFE8315075-1B    LIFE8315090-1B

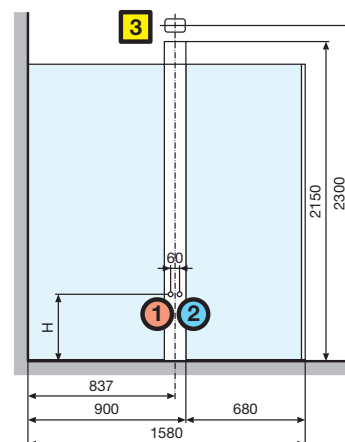

400 ≤ H ≤ 500

LIFE8316070-1B    LIFE8316080-1B  
LIFE8316075-1B    LIFE8316090-1B

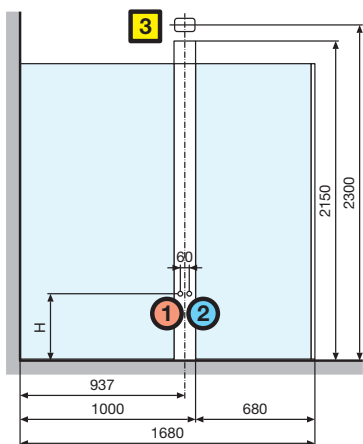

400 ≤ H ≤ 500

LIFE8317070-1B    LIFE8317080-1B  
LIFE8317075-1B    LIFE8317090-1B

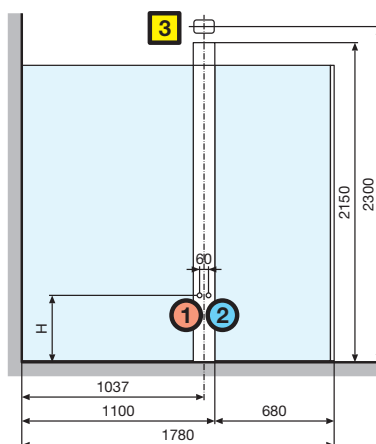

400 ≤ H ≤ 500

LIFE8318070-1B    LIFE8318080-1B  
LIFE8318075-1B    LIFE8318090-1B

- 1** Allaccio idraulico acqua calda rubinetteria.  
*Hot water tap pipe connection.*
- 2** Allaccio idraulico acqua fredda rubinetteria.  
*Cold water tap pipe connection.*
- 3** Allaccio elettrico.  
*Electrical connection.*

#### CARATTERISTICHE IDRAULICHE

- Pressione dinamica ottimale 2÷5 bar
- Allaccio acqua calda 1/2"
- Allaccio acqua fredda 1/2"

#### CARATTERISTICHE ELETTRICHE

- Tensione 230 V
- Frequenza 50 Hz
- Potenza massima assorbita: 40 W

#### HYDRAULIC FEATURES

- *Optimum dynamic pressure 2-5 bar*
- *1/2" hot water connection*
- *Cold water connection 1/2"*

#### ELECTRICAL FEATURES

- *Supply voltage 230 V*
- *Frequency 50 Hz*
- *Maximum absorbed power: 40 W*

Installare a monte dell'apparecchio un interruttore differenziale da 30mA provvisto di interruttore onnipolare con apertura minima dei contatti ≥ 3 mm.

*Install a 30 mA differential switch upstream of the unit. The switch should be fitted with a circuit breaker with minimum contact opening ≥ 3 mm.*